



PBRERA-SAS79-PR0817
www.rera.punjab.gov.in



THE ZIRK

Luxury Residences at High Ground

3 & 3+1 BHK APARTMENTS

HOMES IN THE HEART OF NATURE



THIS IS ZIRK
Living
Surrounded by
21000 Fully Grown Trees

Come home to The Zirk, Zirakpur's premier nature-centric, amenities rich, approx 4 acre sustainable township. Join a beautiful vibrant community of hills, trees, birds, flowers and like-minded biophiles. Well connected with Tricity's infrastructure The Zirk weaves nature and modern lifestyle together to create a balance that you have never felt before.



celebrate
EVERY MOMENT OF YOUR LIFE...



CLUB HOUSE AMENITIES

- Banquet Hall
- Indoor & Outdoor Gymnasium
- Yoga, Meditation Centre, Dance Studio & Aerobics
- Conference Room cum Co-Working spaces
- Restaurant & Coffee House
- Indoor Gaming Zone
- Facilities for Swimming Pool & Indoor Games
- Play-Way Crèche
- In House Mini-Theatre
- Roof Top Swimming Pool
- Sauna & Steam Bath
- Library
- Fully Wifi Zone

Unmatched living
experience



PROJECT AMENITIES

-  POLLUTION FREE ENVIRONMENT
-  GREEN AREAS WITH AYURVEDIC PLANTS
-  KIDS PLAY ZONE
-  GATED TOWNSHIP WITH 24X7 SECURITY
-  CONNECTIVITY FROM CHANDIGARH AND INTERNATIONAL AIRPORT
-  IN CAMPUS RETAIL COMPLEX
-  BADMINTON COURT, JOGGING TRACK & OTHER SPORTS FACILITIES
-  FIBRE CONNECTIVITY
-  IN CAMPUS EV STATION
-  24X7 ELECTRICITY & WATER SUPPLY
-  RAIN WATER HARVESTING
-  CCTV SURVEILLANCE
-  FIRE FIGHTING SYSTEM
-  IN HOUSE FIRST AID FACILITY



SITE PLAN

TECHNICAL SPECIFICATIONS

| | |
|---------------------------|--|
| LIVING/DINING ROOM | Flooring / Skirting: Glazed Vitrified Tiles. Wall Finish: Plaster & Superior Plastic Emulsion Paint. |
| MODULAR KITCHEN | Modular Cabinets with accessories Flooring/Skirting: Glazed Vitrified Tiles. |
| BED ROOMS | Flooring : Master Bedroom with Wooden Flooring/Other Bedroom (Vitrified Tiles) Wood Work: Wooden Wardrobes |
| TOILETS | Flooring/Skirting: Anti-skid tiles & Designer Glazed Tiles on walls. Fitting : Chinaware Fittings & CP Fittings from a reputed brand. |
| BALCONY | Flooring / Skirting: Anti-Skid Tiles. Wall Finish: Plaster & Weather Proof Exterior Paint Railing: MS/Glass Railing upto 4th floor |
| ELECTRICAL | Cables, Switches & Sockets of Good Brands, Necessary Points for AC, Geyser etc. |
| STAIR CASE | Flooring / Skirting: Marble/Granite/Engineered Marble Slabs Railing: MS Railing |
| STRUCTURE | Earthquake resistant structure designed as per the IS codes. |
| LIFTS | Lifts of a reputed brand |
| SMART HOMES | Fully Automated Apartments |



TOWER - A (TYPE-3BHK + SERVANT)

SUPER AREA = 2290 SQ. FT



Disclaimer: Dimensions are approximate and the furniture, fixtures and interior items shown inside the layout are not the part of standard fittings and chargeable.



TOWER - A (TYPE-3BHK + SERVANT) SINGLE FLAT AREA SUPER AREA = 2290 SQ. FT

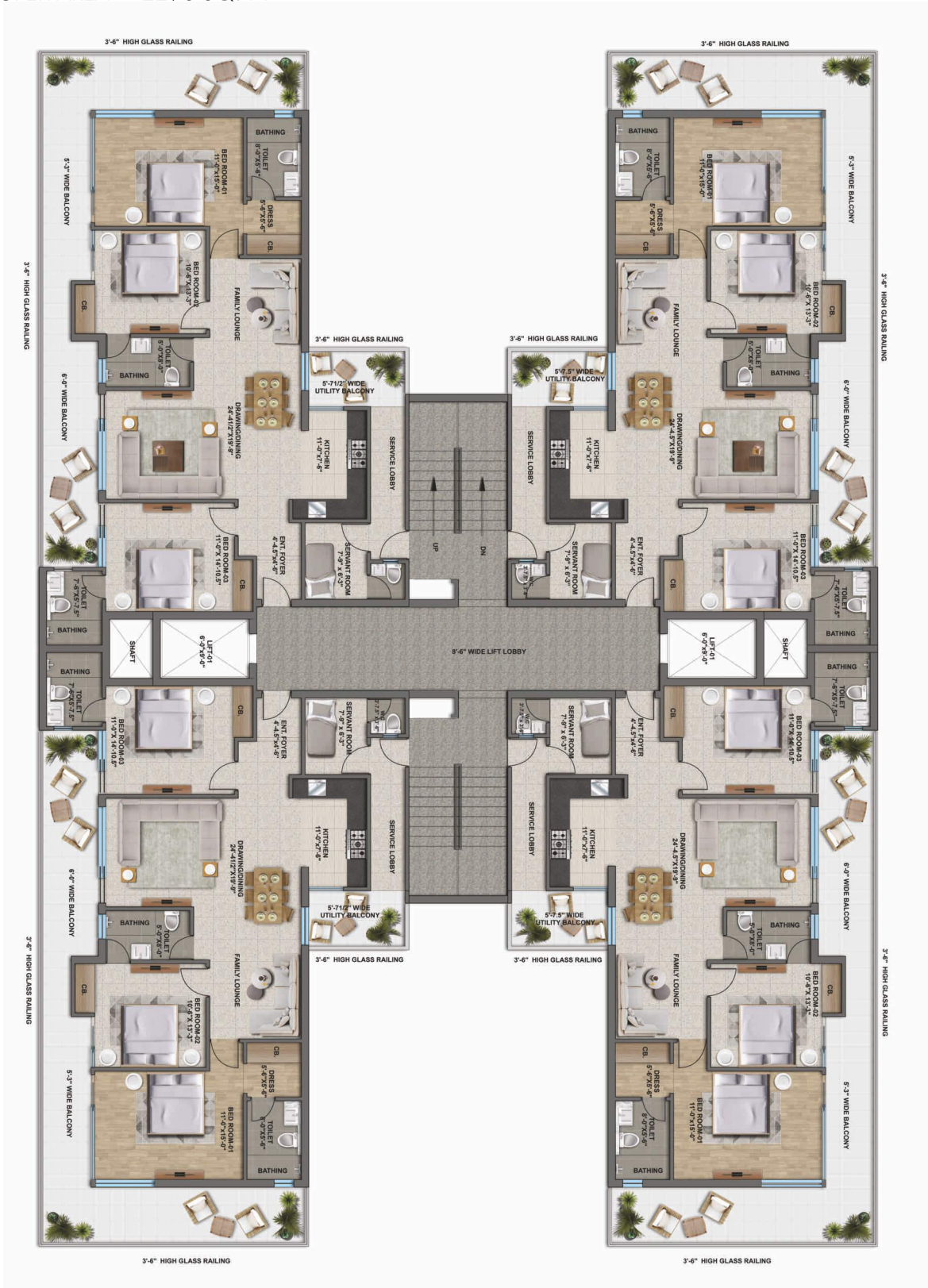

Disclaimer: Dimensions are approximate and the furniture, fixtures and interior items shown inside the layout are not the part of standard fittings and chargeable.



TOWER - B (TYPE-3BHK)

SUPER AREA = 1800 SQ. FT



Disclaimer: Dimensions are approximate and the furniture, fixtures and interior items shown inside the layout are not the part of standard fittings and chargeable.



TOWER - B (TYPE-3BHK)
SUPER AREA = 1750 SQ. FT



Disclaimer: Dimensions are approximate and the furniture, fixtures and interior items shown inside the layout are not the part of standard fittings and chargeable.



TOWER - B (TYPE-3BHK)

SUPER AREA = 1800 SQ. FT



Disclaimer: Dimensions are approximate and the furniture, fixtures and interior items shown inside the layout are not the part of standard fittings and chargeable.



TOWER - C (TYPE-3BHK) SINGLE FLAT AREA

SUPER AREA = 1990 SQ. FT



Disclaimer: Dimensions are approximate and the furniture, fixtures and interior items shown inside the layout are not the part of standard fittings and chargeable.



TOWER - C (TYPE-3BHK)

SUPER AREA = 1900 SQ. FT



Disclaimer: Dimensions are approximate and the furniture, fixtures and interior items shown inside the layout are not the part of standard fittings and chargeable.



TOWER - D (TYPE-3BHK)

SUPER AREA = 1990 SQ. FT

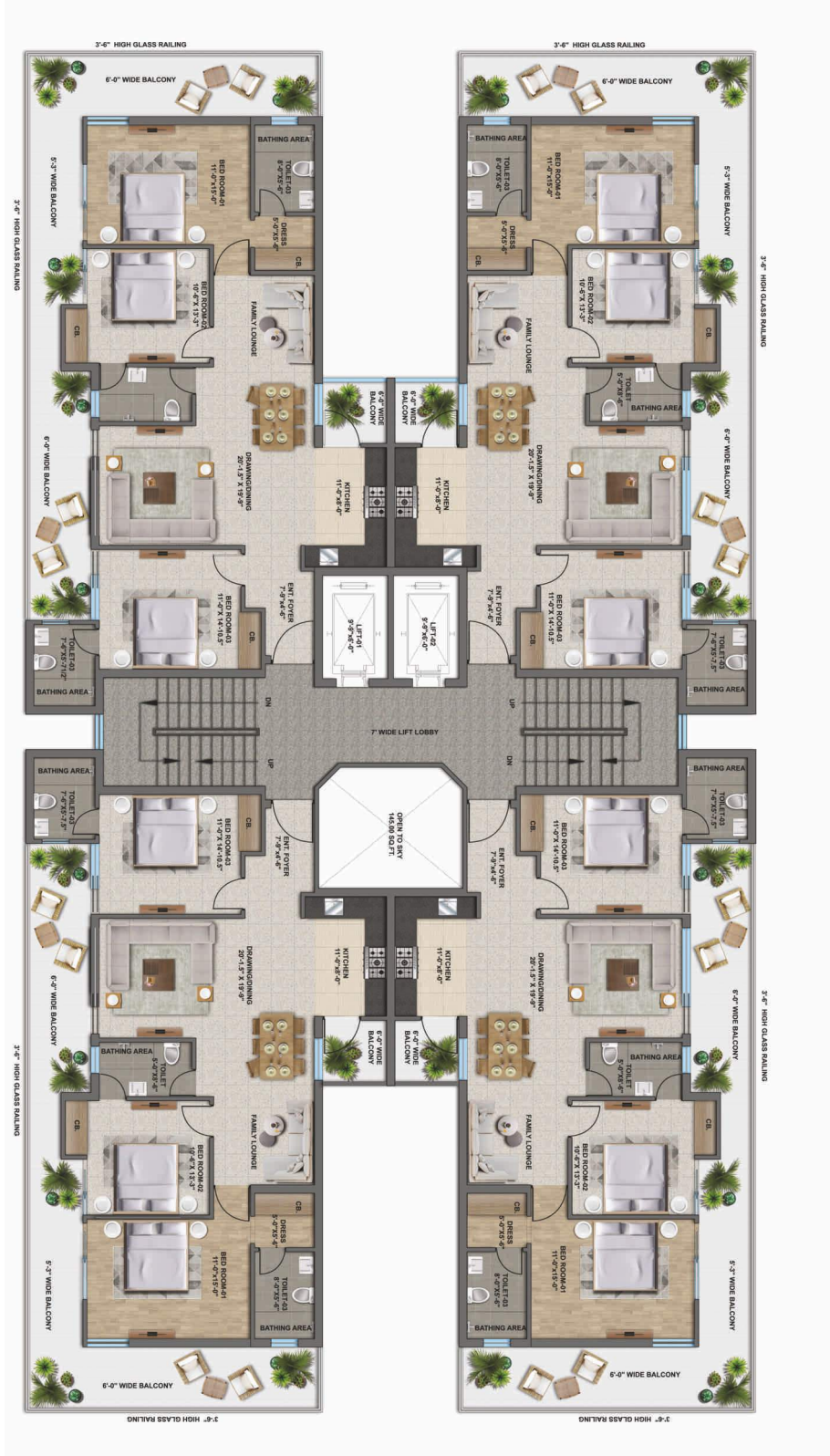

Disclaimer: Dimensions are approximate and the furniture, fixtures and interior items shown inside the layout are not the part of standard fittings and chargeable.



TOWER - D (TYPE-3BHK)

SUPER AREA = 1990 SQ. FT



Disclaimer: Dimensions are approximate and the furniture, fixtures and interior items shown inside the layout are not the part of standard fittings and chargeable.

LOCATION MAP



THE ZIRK
Luxury Residences at High Ground

LOCATION ADVANTAGES

2 Min.



HLP SOCIAL SQUARE

MOHALI CITY SQUARE

HP PETROL PUMP

GOPAL SWEETS

5 Min.

BEST PRICE & METRO

MCD/KFC/
BURGER KING

AMCARE
HOSPITAL

DECATHLON

AMITY UNIVERSITY

PVR CINEMA

10 Min.

INTERNATIONAL AIRPORT

IT CITY & AERO CITY

ELANTE MALL

ST. XAVIERS SCHOOL

RAILWAY STATION

A PROJECT BY



High Ground Road, Zirakpur - Patiala Highway, Punjab

Disclaimer - This brochure is purely conceptual and do not constitute a legal binding offer. All images are artistic impressions and not necessarily fully representative in the interest of maintaining high standards. The contents herein including all services, infrastructure, products, designs, amenities, facilities, site plan, layout plans, floor plans, dimensions, specifications, elevation and perspective views are tentative in nature and all subject to variations and modifications without notice till the final completion of the project at the sole discretion of Competent Statutory Authorities of the company. Architectural features may differ in different apartments. Soft furniture and gadgets are not part standard offering. All images are artistic conceptualisation and does not purport to replicate the exact product. The Zirk is a Government approved project.